

# ADOR

THE PENINSULA BURSOOD

by mirvac

1 BED | 1 BATH | 1 CAR

Type	Typical 1 Bed Apartment
Internal Area	53 m <sup>2</sup>
External Area	9 m <sup>2</sup>
Total Area	62 m <sup>2</sup>

Note: Tiling upgrade shown on plan. Areas subject to change in accordance with the provisions of the contract. Area includes balcony and/or terrace where applicable. It excludes associated parking and external storage areas.

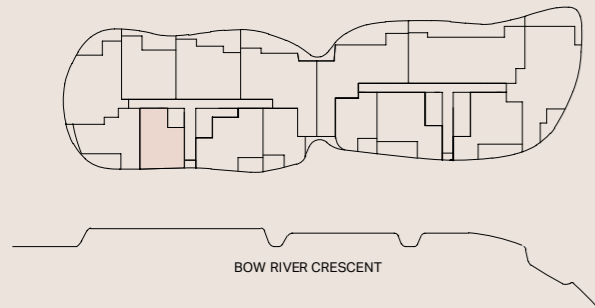

## LEGEND - AS APPLICABLE

△ Access	F Fridge	K King Bed
△ Balcony Access	L Linen	O Oven
* Planter - Common Property	P Pantry	S Storage
** Non Trafficable	Q Queen Bed	C Comms
R Robe Fitout	JN Joinery	G Grass

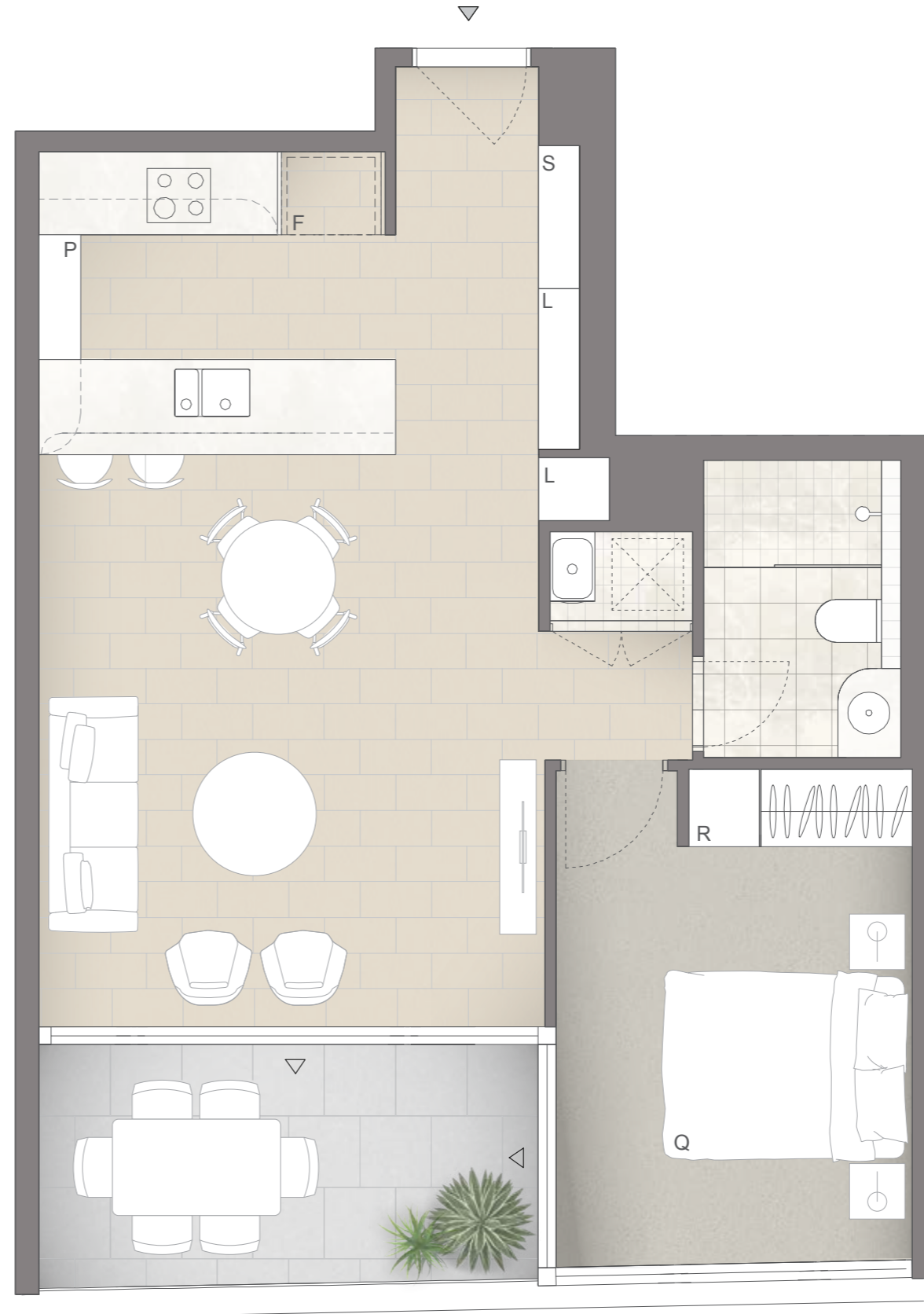

IMPORTANT NOTICE: This floor plan was produced prior to construction and while the information contained herein is believed to be correct it is not guaranteed. Changes will undoubtedly be made in accordance with the contract for sale. The plan does not show additional features such as hot water systems, services or Bulkheads necessary for services. Dimensions, areas and scale of floor plans are approximate only and subject to the terms of the Contract. Areas calculated in accordance with the Property Council of Australia Method of Measurement. The furniture and furnishings depicted are not included with any sale. Purchasers must refer to the contract for sale for the list of inclusions. Furnishings should not be taken to indicate the final position of power points, TV connection points and the like. All graphics, including design and extent of tile/paver/ carpet areas, landscaping, balustrades, fencing, privacy screens, and services equipment are for illustrative purposes only and are not to be relied on as a representative of the final product. All level changes in the courtyards may not have been shown.



# ADOR

THE PENINSULA BURSOOD

by mirvac

2 BED | 1 BATH | 1 CAR

Type	Typical 2 Bed Apartment
Internal Area	77 m <sup>2</sup>
External Area	14 m <sup>2</sup>
Total Area	91 m <sup>2</sup>

Note: Tiling upgrade shown on plan. Areas subject to change in accordance with the provisions of the contract. Area includes balcony and/or terrace where applicable. It excludes associated parking and external storage areas.

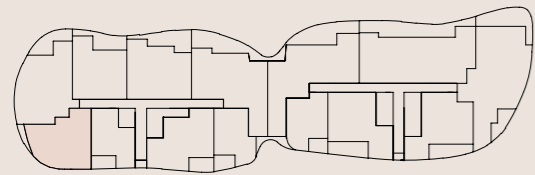

BOW RIVER CRESCENT

## LEGEND - AS APPLICABLE

△ Access	F Fridge	K King Bed
△ Balcony Access	L Linen	O Oven
* Planter - Common Property	P Pantry	S Storage
** Non Trafficable	Q Queen Bed	C Comms
R Robe Fitout	JN Joinery	G Grass

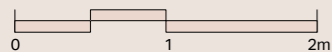

IMPORTANT NOTICE: This floor plan was produced prior to construction and while the information contained herein is believed to be correct it is not guaranteed. Changes will undoubtedly be made in accordance with the contract for sale. The plan does not show additional features such as hot water systems, services or Bulkheads necessary for services. Dimensions, areas and scale of floor plans are approximate only and subject to the terms of the Contract. Areas calculated in accordance with the Property Council of Australia Method of Measurement. The furniture and furnishings depicted are not included with any sale. Purchasers must refer to the contract for sale for the list of inclusions. Furnishings should not be taken to indicate the final position of power points, TV connection points and the like. All graphics, including design and extent of tile/paver/ carpet areas, landscaping, balustrades, fencing, privacy screens, and services equipment are for illustrative purposes only and are not to be relied on as a representative of the final product. All level changes in the courtyards may not have been shown.



# ADOR

THE PENINSULA BURSWOOD

by mirvac

2 BED | 2 BATH | 1 CAR

Type	Typical 2 Bed Apartment
Internal Area	84 m <sup>2</sup>
External Area	17 m <sup>2</sup>
Total Area	101 m <sup>2</sup>

Note: Tiling upgrade shown on plan. Areas subject to change in accordance with the provisions of the contract. Area includes balcony and/or terrace where applicable. It excludes associated parking and external storage areas.

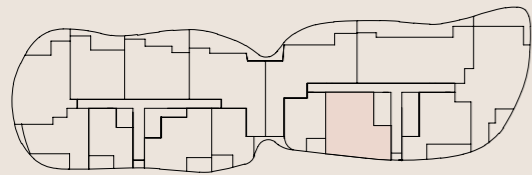

BOW RIVER CRESCENT

## LEGEND - AS APPLICABLE

△ Access	F Fridge	K King Bed
△ Balcony Access	L Linen	O Oven
* Planter - Common Property	P Pantry	S Storage
** Non Trafficable	Q Queen Bed	C Comms
R Robe Fitout	JN Joinery	G Grass



IMPORTANT NOTICE: This floor plan was produced prior to construction and while the information contained herein is believed to be correct it is not guaranteed. Changes will undoubtedly be made in accordance with the contract for sale. The plan does not show additional features such as hot water systems, services or Bulkheads necessary for services. Dimensions, areas and scale of floor plans are approximate only and subject to the terms of the Contract. Areas calculated in accordance with the Property Council of Australia Method of Measurement. The furniture and furnishings depicted are not included with any sale. Purchasers must refer to the contract for sale for the list of inclusions. Furnishings should not be taken to indicate the final position of power points, TV connection points and the like. All graphics, including design and extent of tile/paver/ carpet areas, landscaping, balustrades, fencing, privacy screens, and services equipment are for illustrative purposes only and are not to be relied on as a representative of the final product. All level changes in the courtyards may not have been shown.



# ADOR

THE PENINSULA BURSOOD

by mirvac

2 BED | 2 BATH | 2 CAR

Type	Typical 2 Bed Garden Apartment
Internal Area	81 m <sup>2</sup>
External Area	72 m <sup>2</sup>
Total Area	153 m <sup>2</sup>

Note: Tiling upgrade shown on plan. Areas subject to change in accordance with the provisions of the contract. Area includes balcony and/or terrace where applicable. It excludes associated parking and external storage areas.

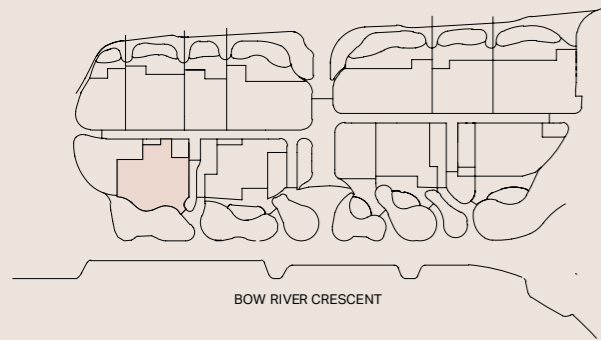

## LEGEND - AS APPLICABLE

△ Access	F Fridge	K King Bed
△ Balcony Access	L Linen	O Oven
* Planter - Common Property	P Pantry	S Storage
** Non Trafficable	Q Queen Bed	C Comms
R Robe Fitout	JN Joinery	G Grass



IMPORTANT NOTICE: This floor plan was produced prior to construction and while the information contained herein is believed to be correct it is not guaranteed. Changes will undoubtedly be made in accordance with the contract for sale. The plan does not show additional features such as hot water systems, services or Bulkheads necessary for services. Dimensions, areas and scale of floor plans are approximate only and subject to the terms of the Contract. Areas calculated in accordance with the Property Council of Australia Method of Measurement. The furniture and furnishings depicted are not included with any sale. Purchasers must refer to the contract for sale for the list of inclusions. Furnishings should not be taken to indicate the final position of power points, TV connection points and the like. All graphics, including design and extent of tile/paver/ carpet areas, landscaping, balustrades, fencing, privacy screens, and services equipment are for illustrative purposes only and are not to be relied on as a representative of the final product. All level changes in the courtyards may not have been shown.



# ADOR

THE PENINSULA BURSWOOD

by mirvac

2 BED | 2 BATH | 2 CAR

Type	Typical 2 Bed Apartment
Internal Area	111 m <sup>2</sup>
External Area	18 m <sup>2</sup>
Total Area	129 m <sup>2</sup>

Note: Tiling upgrade shown on plan. Areas subject to change in accordance with the provisions of the contract. Area includes balcony and/or terrace where applicable. It excludes associated parking and external storage areas.

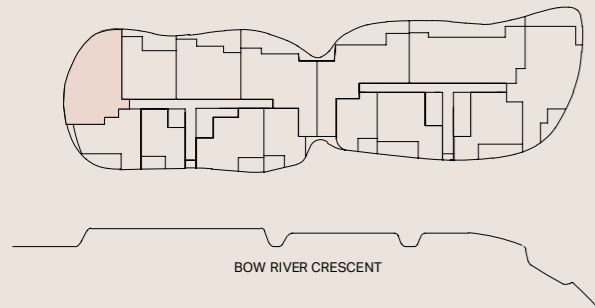

## LEGEND - AS APPLICABLE

△ Access	F Fridge	K King Bed
△ Balcony Access	L Linen	O Oven
* Planter - Common Property	P Pantry	S Storage
** Non Trafficable	Q Queen Bed	C Comms
R Robe Fitout	JN Joinery	G Grass



IMPORTANT NOTICE: This floor plan was produced prior to construction and while the information contained herein is believed to be correct it is not guaranteed. Changes will undoubtedly be made in accordance with the contract for sale. The plan does not show additional features such as hot water systems, services or Bulkheads necessary for services. Dimensions, areas and scale of floor plans are approximate only and subject to the terms of the Contract. Areas calculated in accordance with the Property Council of Australia Method of Measurement. The furniture and furnishings depicted are not included with any sale. Purchasers must refer to the contract for sale for the list of inclusions. Furnishings should not be taken to indicate the final position of power points, TV connection points and the like. All graphics, including design and extent of tile/paver/ carpet areas, landscaping, balustrades, fencing, privacy screens, and services equipment are for illustrative purposes only and are not to be relied on as a representative of the final product. All level changes in the courtyards may not have been shown.



# ADOR

THE PENINSULA BURSOOD

by mirvac

3 BED | 2 BATH | 2 CAR

Type	Typical 3 Bed Apartment
Internal Area	129 m <sup>2</sup>
External Area	30 m <sup>2</sup>
Total Area	164 m <sup>2</sup>

Note: Tiling upgrade shown on plan. Areas subject to change in accordance with the provisions of the contract. Area includes balcony and/or terrace where applicable. It excludes associated parking and external storage areas.

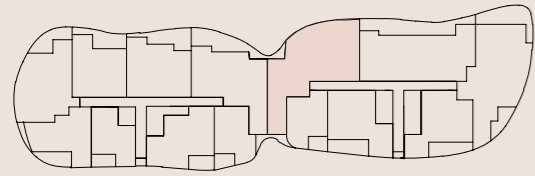

BOW RIVER CRESCENT

## LEGEND - AS APPLICABLE

△ Access	F Fridge	K King Bed
△ Balcony Access	L Linen	O Oven
* Planter - Common Property	P Pantry	S Storage
** Non Trafficable	Q Queen Bed	C Comms
R Robe Fitout	JN Joinery	G Grass

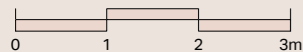

IMPORTANT NOTICE: This floor plan was produced prior to construction and while the information contained herein is believed to be correct it is not guaranteed. Changes will undoubtedly be made in accordance with the contract for sale. The plan does not show additional features such as hot water systems, services or Bulkheads necessary for services. Dimensions, areas and scale of floor plans are approximate only and subject to the terms of the Contract. Areas calculated in accordance with the Property Council of Australia Method of Measurement. The furniture and furnishings depicted are not included with any sale. Purchasers must refer to the contract for sale for the list of inclusions. Furnishings should not be taken to indicate the final position of power points, TV connection points and the like. All graphics, including design and extent of tile/paver/ carpet areas, landscaping, balustrades, fencing, privacy screens, and services equipment are for illustrative purposes only and are not to be relied on as a representative of the final product. All level changes in the courtyards may not have been shown.



# ADOR

THE PENINSULA BURSOOD

by mirvac

3 BED | 2 BATH | 2 CAR

Type Typical 3 Bed Dual Living Apartment

Internal Area 160 m<sup>2</sup>

External Area 38 m<sup>2</sup>

Total Area 198 m<sup>2</sup>

Note: Tiling upgrade shown on plan. Areas subject to change in accordance with the provisions of the contract. Area includes balcony and/or terrace where applicable. It excludes associated parking and external storage areas.

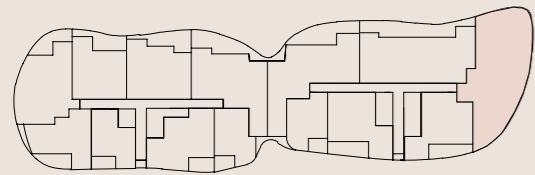

BOW RIVER CRESCENT

## LEGEND - AS APPLICABLE

- |                             |             |            |
|-----------------------------|-------------|------------|
| △ Access                    | F Fridge    | K King Bed |
| △ Balcony Access            | L Linen     | O Oven     |
| * Planter - Common Property | P Pantry    | S Storage  |
| ** Non Trafficable          | Q Queen Bed | C Comms    |
| R Robe Fitout               | JN Joinery  | G Grass    |



IMPORTANT NOTICE: This floor plan was produced prior to construction and while the information contained herein is believed to be correct it is not guaranteed. Changes will undoubtedly be made in accordance with the contract for sale. The plan does not show additional features such as hot water systems, services or Bulkheads necessary for services. Dimensions, areas and scale of floor plans are approximate only and subject to the terms of the Contract. Areas calculated in accordance with the Property Council of Australia Method of Measurement. The furniture and furnishings depicted are not included with any sale. Purchasers must refer to the contract for sale for the list of inclusions. Furnishings should not be taken to indicate the final position of power points, TV connection points and the like. All graphics, including design and extent of tile/paver/ carpet areas, landscaping, balustrades, fencing, privacy screens, and services equipment are for illustrative purposes only and are not to be relied on as a representative of the final product. All level changes in the courtyards may not have been shown.



# ADOR

THE PENINSULA BURSWOOD

by mirvac

3 BED | 3 BATH | 2 CAR

Type	Typical 3 Bed + Study Apartment
Internal Area	157 m <sup>2</sup>
External Area	41 m <sup>2</sup>
Total Area	198 m <sup>2</sup>

Note: Tiling upgrade shown on plan. Areas subject to change in accordance with the provisions of the contract. Area includes balcony and/or terrace where applicable. It excludes associated parking and external storage areas.

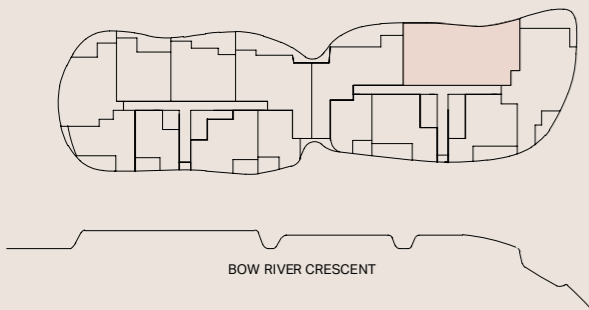

## LEGEND - AS APPLICABLE

△ Access	F Fridge	K King Bed
△ Balcony Access	L Linen	O Oven
* Planter - Common Property	P Pantry	S Storage
** Non Trafficable	Q Queen Bed	C Comms
R Robe Fitout	JN Joinery	G Grass

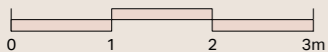

IMPORTANT NOTICE: This floor plan was produced prior to construction and while the information contained herein is believed to be correct it is not guaranteed. Changes will undoubtedly be made in accordance with the contract for sale. The plan does not show additional features such as hot water systems, services or Bulkheads necessary for services. Dimensions, areas and scale of floor plans are approximate only and subject to the terms of the Contract. Areas calculated in accordance with the Property Council of Australia Method of Measurement. The furniture and furnishings depicted are not included with any sale. Purchasers must refer to the contract for sale for the list of inclusions. Furnishings should not be taken to indicate the final position of power points, TV connection points and the like. All graphics, including design and extent of tile/paver/ carpet areas, landscaping, balustrades, fencing, privacy screens, and services equipment are for illustrative purposes only and are not to be relied on as a representative of the final product. All level changes in the courtyards may not have been shown.

